

FLOOR PLAN

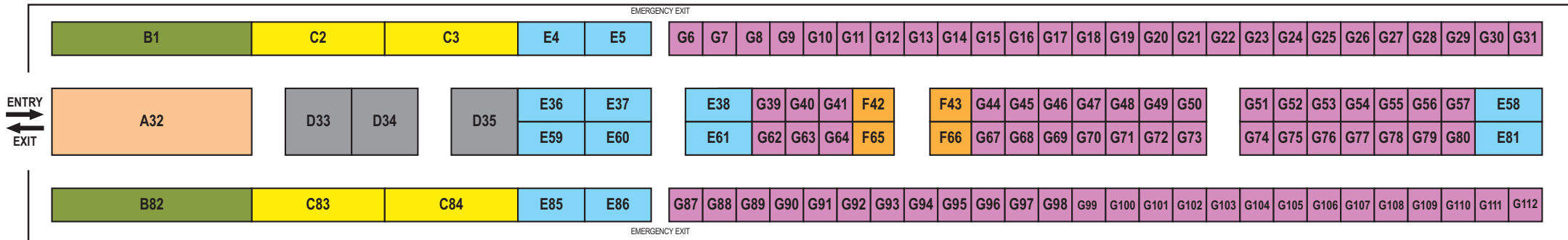

HALL - A

Bombay Exhibition Centre Goregaon, Mumbai



Stand Amenities

- Company Fascia Name
- White Modular Built-up Stand
- Panels (Back & Side Octonorm Walls)
- 1 Table, 2 Chairs, 2 Spotlights, Dustbin
- One Electric Point (5 Amp). Additional facilities at nominal extra charges.

Cost Effective Stand Drifts

These are early bird rates. Premium Stall Space & Shell scheme options are available
Two options are available:
Raw Non AC Spaces also available.
Raw Space - Rs. 12,000 /- per sq.mtr
Builtup Stand - Rs. 12,500 /- per sq mt
15 - 20 % Premium on Corner Stalls
• Overseas Exhibitors (Tariffs in US \$ or Euros)
• Space - US \$ 200 per sq mt.
• Shell - US \$ 215 or Euro € 185 per sq mt.
(18 % GST applicable on all payments).

Legend

| | |
|---|-----------------------|
| A | 18 X 6 = 108 sq. Mtrs |
| B | 18 X 3 = 54 sq. Mtrs |
| C | 12 X 3 = 36 sq. Mtrs |
| D | 6 X 6 = 36 sq. Mtrs |
| E | 6 X 3 = 18 sq. Mtrs |
| F | 4 X 3 = 12 sq. Mtrs |
| G | 3 X 3 = 9 sq. Mtrs |

* Floor Plan Subject to Change

Professional Producers



3 GUINNESS
WR HOLDERS

PROMOTED BY



TRINITY
ISO 9001:2015

Certified by



American National Standards Institute
International Conformance Veritas



PATRON MEMBER
EU INDIA CHAMBERS



ASSOCIATE
MAHARATTA CHAMBER



IMPORT - EXPORT
& HEALTH CHAMBER

www.trinityworld.biz | +91 9769555657 | trinity.cmd@gmail.com